

MOUNTING ARRANGEMENT

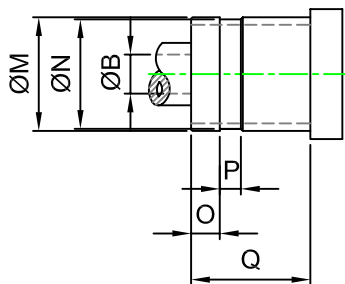

QUICK CONNECTION
ROTOR DETAIL

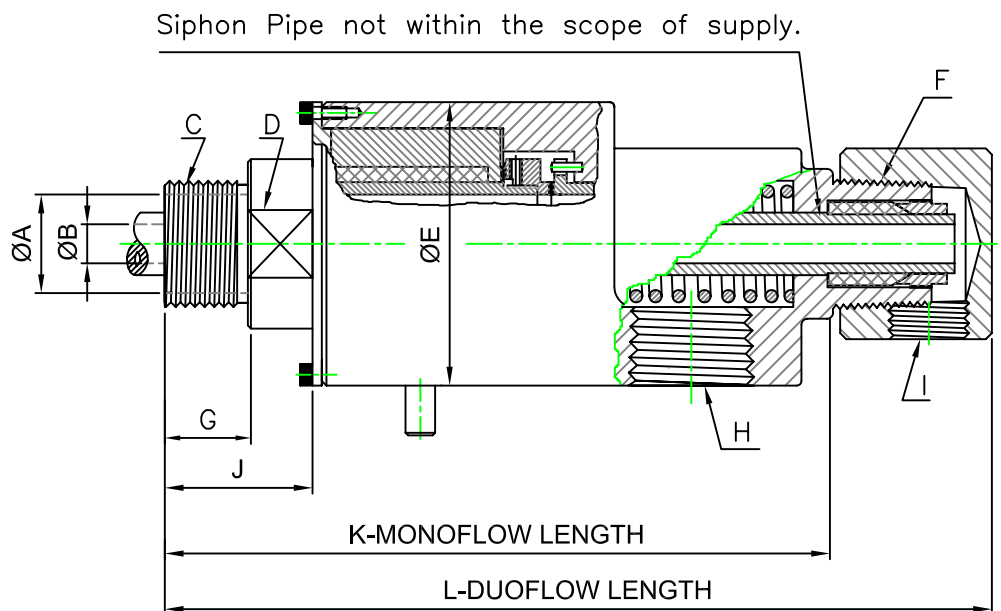

R-202 ROTARY UNION

High Temperature Service Union. Rotor and Outer Body made of temperature resistant steels. Optically flat lapped Tungsten Carbide Seals are held by 99.99% pure graphite bushing to withstand very high temperature of the Thermic fluids.

OPERATING DATA :-

Max. RPM - 250

Max. Temperature - 350° C

Max. Pressure - 5 Kg. / Cm.²